

125C Mill Street, East Malling

Guide Price £300,000

🛏️ 2 🍷 2 🚗 1



Guide Price £300,000 to £325,000. Please Quote RF0924 for all Enquires. This charming ground-floor apartment on Mill Street, East Malling, offers modern living with a spacious open-plan kitchen and living area, two double bedrooms with built-in wardrobes, and a luxurious fully tiled bathroom. The private block-paved garden provides a perfect space for relaxation. Additional features include allocated parking, double glazing, and efficient heating. Located in a picturesque village with local amenities and excellent transport links, this home is ideal for first-time buyers or downsizers seeking a stylish, move-in-ready property.

Key Features

- Guide Price £300,000 to £325,000
- Please Quote RF0924 for all Enquires.
- Two double bedroom ground floor Maisonette
- Modern open plan kitchen and living area
- Luxurious fully tiled bathroom
- Private block paved garden
- Double glazing throughout
- Excellent transport links
- Located in the charming East Malling village

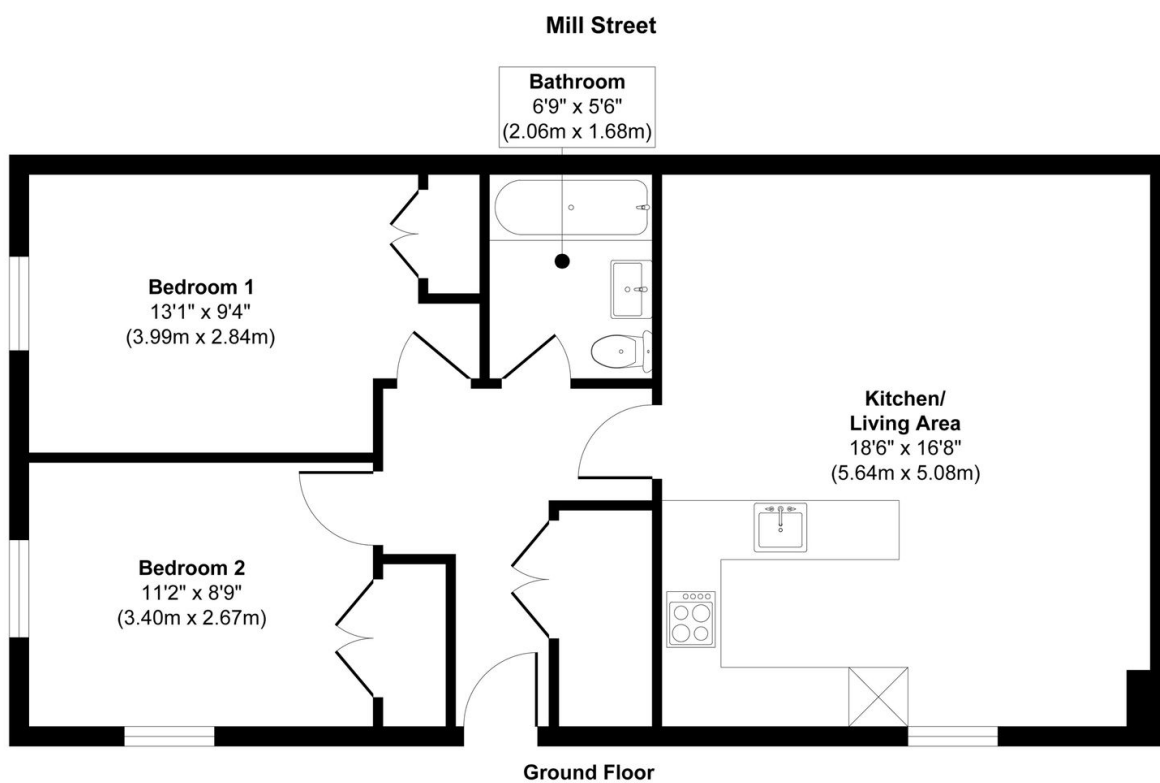

Approx. Gross Internal Floor Area 708 sq. ft / 65.77 sq. m

Illustration for identification purposes only, measurements are approximate, not to scale.
Produced by Elements Property